

THE ANSWER IS SIMPLE

V-RAM MUNICIPAL SLUDGE PUMPS

Differences in municipal sludge pump valve systems provide a clear choice.

Ball check valves:

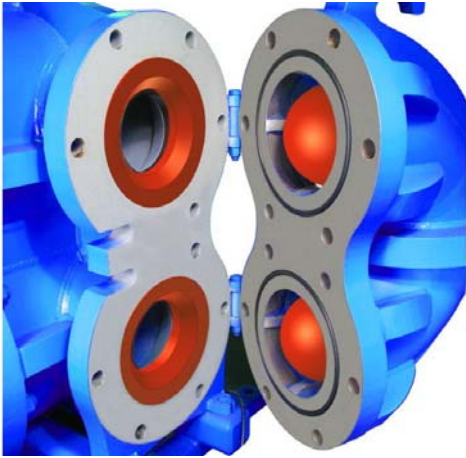

1. Have been in use for centuries in liquid/slurry applications with proven history of reliability and longevity.

2. Have self-cleaning action for rags and other materials which would normally block other types of valves.

3. Have been used by V-RAM in municipal sludge cake pumps over 30,000 hours with no design or wear failures.

4. The effective wear surface of the valve ball is 50 times that of poppet valves. The urethane wear life is ideal for this application.

5. Ball valve components are readily accessible through hinged sections of the pump head and can be replaced within 2-3 minutes after the pump is opened.

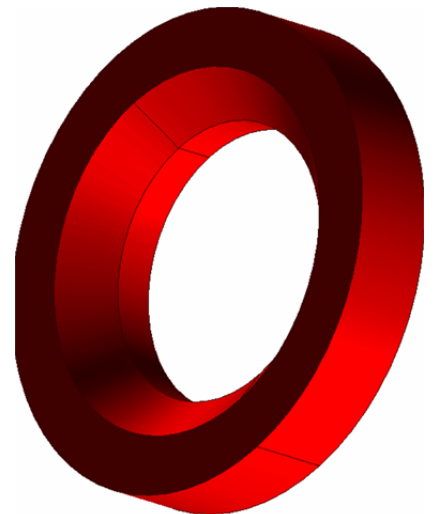
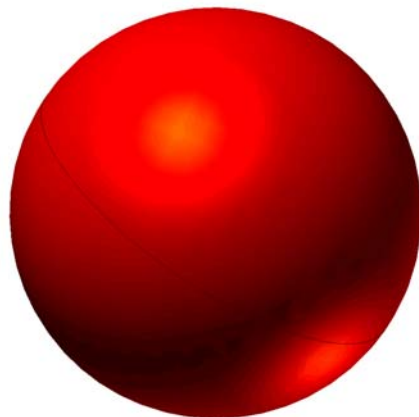
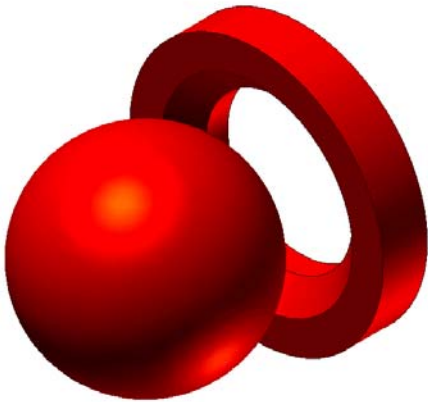

Olson Manufacturing Company
d/b/a "Olson Mfg" and "V-RAM Pumps"
620 S. Broadway Albert Lea, MN 56007 USA
Phone: (888)373-3996 Fax: 507-373-5937
Email: sales@vram.com Website: www.vram.com